

CARACTERÍSTICAS / FEATURES

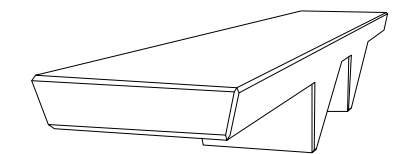

Material hormigón Petra 1
Acabado decapado e hidrofugado
Dimensiones l. 350, a. 60, h. 45 cm
Color ver carta de colores
Fijación apoyado por su propio peso o mediante resina epoxy
Peso 870 Kg
Palet 360 x 70 cm

Material precast concrete Petra 1
Finish etched and waterproofed
Dimensions l. 350, w. 60, h. 45 cm
Colour see colour catalogue
Fixing resting on the ground or with epoxy resin
Weight 870 Kg
Pallet 360 x 70 cm



diseñador / design: In-Tenta

RIPPLE B-350

GEOMETRIA / GEOMETRY

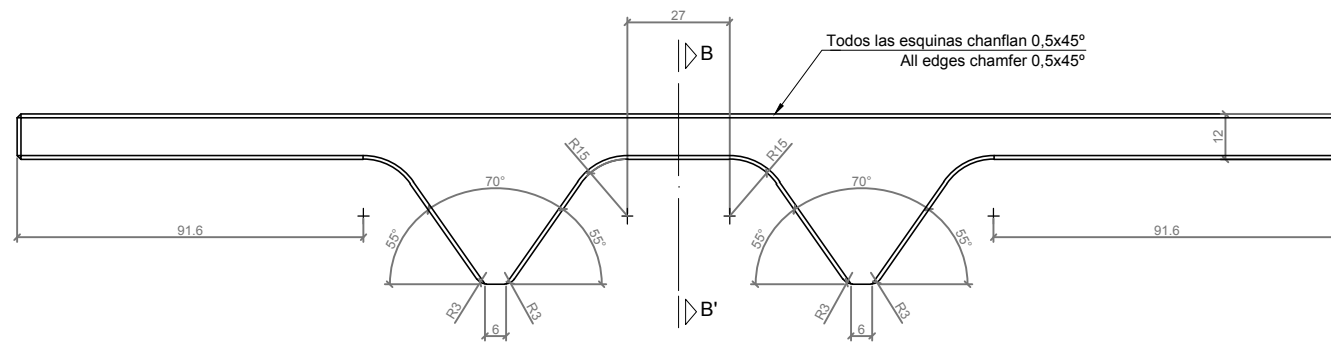

ALZADO / FRONT VIEW

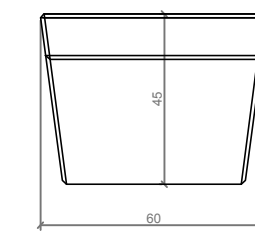

PERFIL / RIGHT SIDE

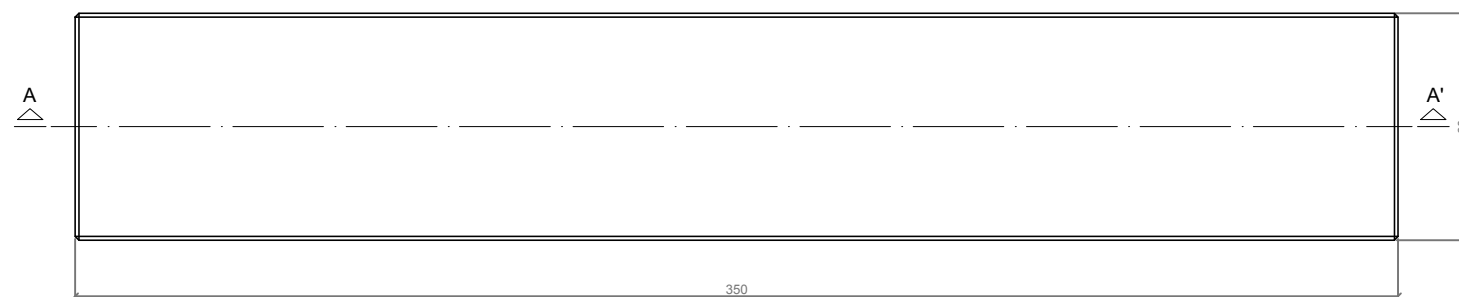

PLANTA / TOP VIEW

ESC. 1:20

ESPECIFICACIONES / SPECIFICATIONS

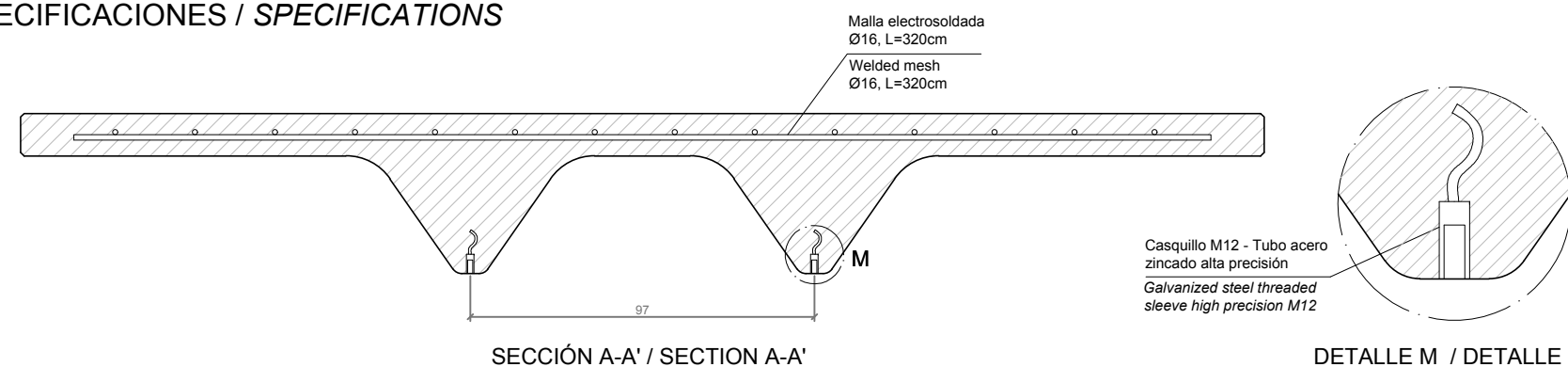

SECCIÓN A-A' / SECTION A-A'

DETALLE M / DETALLE M

MANIPULACIÓN E INSTALACIÓN / HANDLING AND INSTALLATION

- 1 Elevar y enroscar la varilla
lift and thread the rod

Elevación / Hoisting
P= 870 Kg

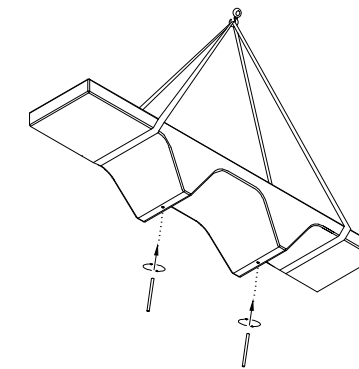

- 2 Perforar agujero y verter resina epoxy
drill hole and pour resin epoxy

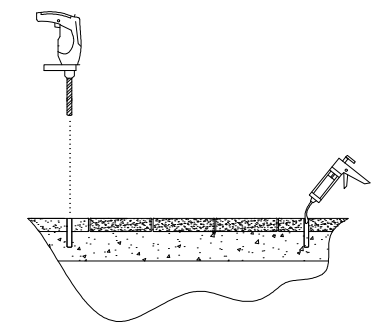

- 3 Insertar la varilla en el agujero para instalar / Insert metal rod in hole for install

