

CARACTERÍSTICAS / FEATURES

Material hormigón petra 1
Acabado decapado e hidrofugado
Dimensiones l. 163.9, a.44.4, h. 49.6 cm.
Color ver carta de colores
Fijación simplemente apoyado o mediante varillas metálicas
Peso 380 Kg
Bulto 180 x 50 x 65 cm
Peso bulto 395 Kg

Material concrete petra 1
Finish scaled and waterproofed
Dimensions l. 163.9, w. 44.4, h. 49.6 cm
Colour see colour catalogue
Fixing resting on the ground or anchored with metal rod
Weight 380 Kg
Package 180 x 50 x 65 cm
Weight package 395 Kg

dineñador / design: EMBT, Benedetta Tagliabue

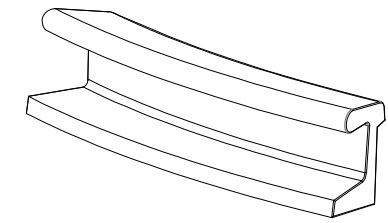

VINYES R726

Tàrrrega, Lleida - Tel. +34 973 15 87 03 - www.magourban.com - info@magourban.com

magourban



GEOMETRIA / GEOMETRY

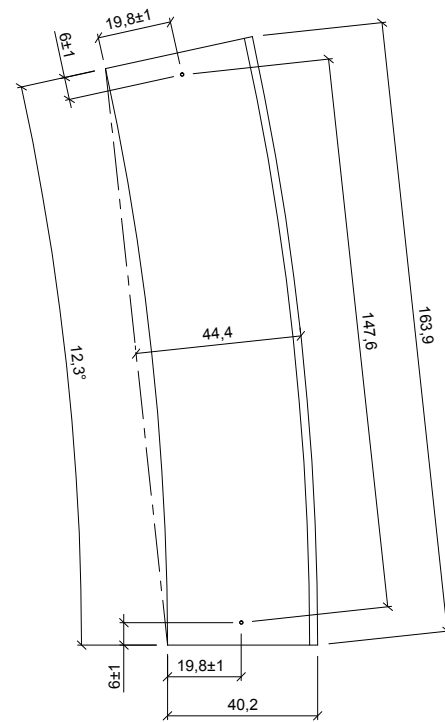
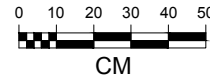

VISTA INFERIOR / BOTTOM VIEW

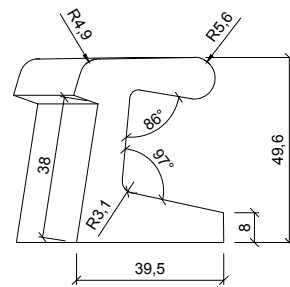

ALZADO / FRONT VIEW

ESPECIFICACIONES / SPECIFICATIONS

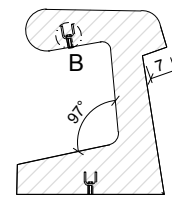

SECCIÓN 1 / SECTION 1

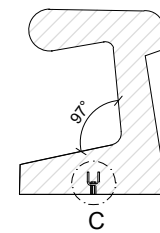

SECCIÓN 2 / SECTION 2

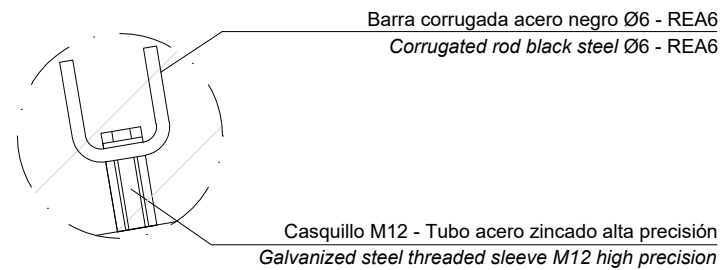

DETALLE B / DETAIL B
[ELEVACIÓN / HOISTING]

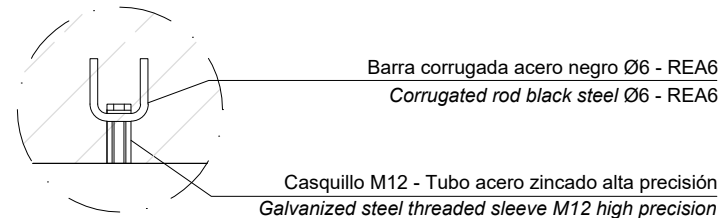

DETALLE C / DETAIL C
[ANCLAJE / ANCHORAGE]

MANIPULACIÓN E INSTALACIÓN / HANDLING AND INSTALLATION

- 1 enroskar cáncamo elevar y enroskar la varilla
thread the eyebolt, lift and threaded the rod
elevación / hoisting
P= 380 Kg

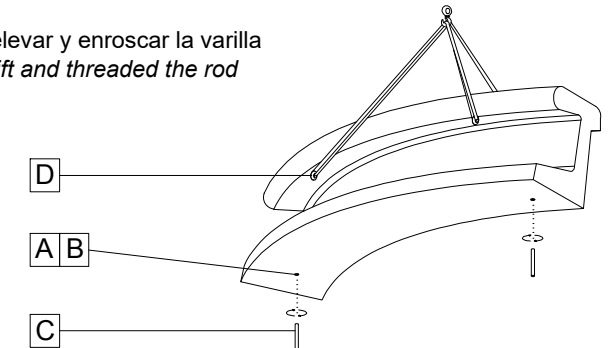

SISTEMA DE ELEVACIÓN / ANCHORAGE SYSTEM

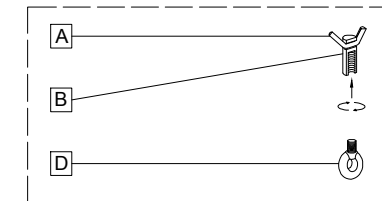

- A barra corrugada / corrugated rod
- B casquillo roscado / thread sleeve
- D cáncamo / eyebolt

SISTEMA DE FIJACIÓN / LIFTING SYSTEM

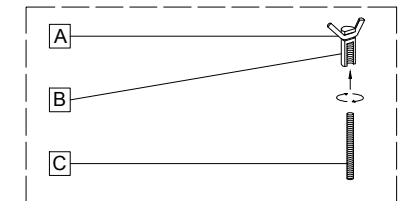

- A barra corrugada / corrugated rod
- B casquillo roscado / thread sleeve
- C varilla roscada / thread the rod

- 2 perforar 2 agujeros a distancia ± 147,6cm
drill 2 holes each at a distance ± 147,6cm
- 3 verter resina epoxy / pour resin epoxy

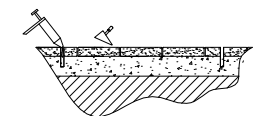
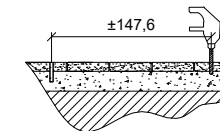

- 4 insertar la varilla en el agujero
insert metal rod in hole

