

**CARACTERÍSTICAS / FEATURES**



**Material** hormigón Petra 1  
**Acabado** decapado e hidrofugado  
**Dimensiones** l. 150, a. 150, h. 80 cm  
**Color** ver carta de colores  
**Fijación** apoyado por su propio peso o mediante resina epoxi  
**Peso** 1150 Kg / 1040 L  
**Palet** 160 x 160 cm

**Material** precast concrete Petra 1  
**Finish** etched and waterproofed  
**Dimensions** l. 150, w. 150, h. 80 cm  
**Colour** see colour catalogue  
**Fixing** resting on the ground or with epoxy resin  
**Weight** 1150 Kg / 1040 L  
**Pallet** 160 x 160 cm

diseñador / design: Ton Riera

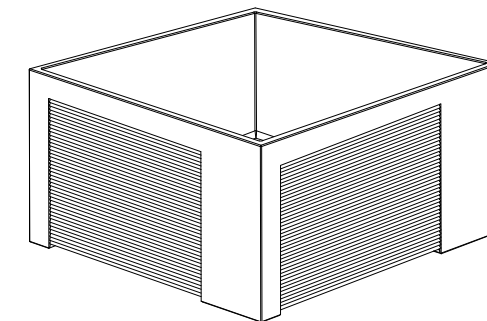

TANIT M

**GEOMETRIA / GEOMETRY**

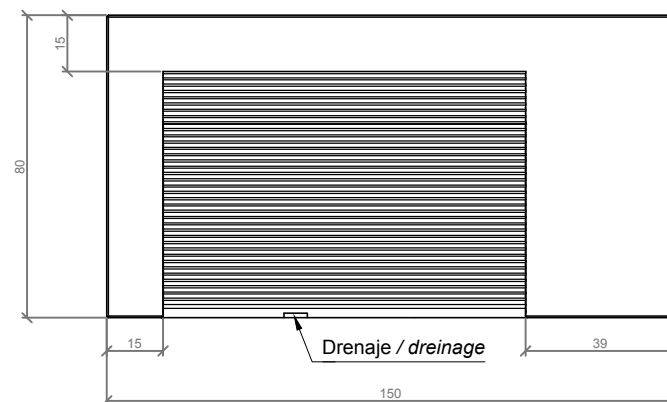

ALZADO / FRONT VIEW

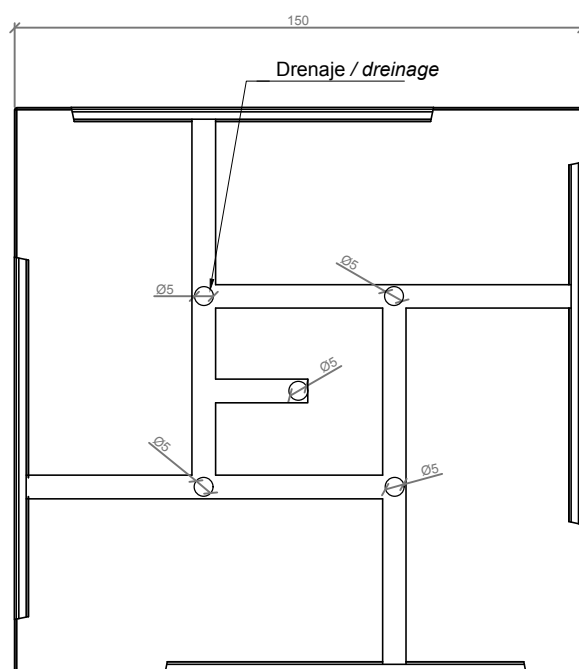

VISTA INFERIOR / BOTTOM VIEW

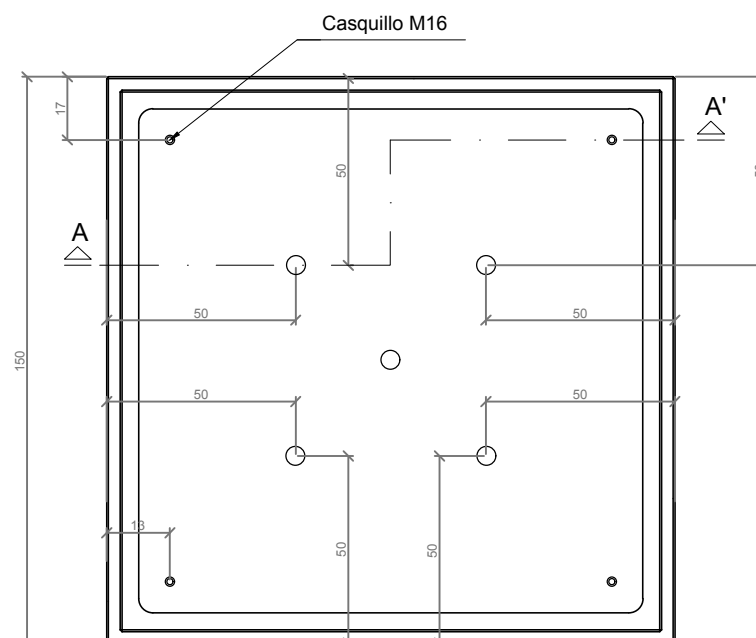

PLANTA / TOP VIEW

ESC. 1:20

**MANIPULACIÓN E INSTALACIÓN / HANDLING AND INSTALLATION**

1 Enroscar cáncamo al casquillo roscado  
 Thread the eyebolt on the thread sleeve

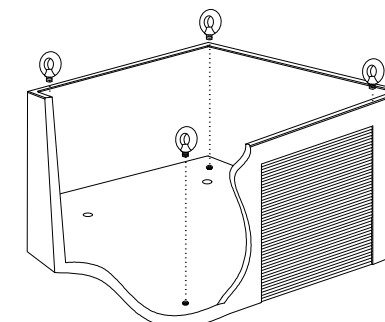

2 Elevar mediante eslingas / Lifting with slings

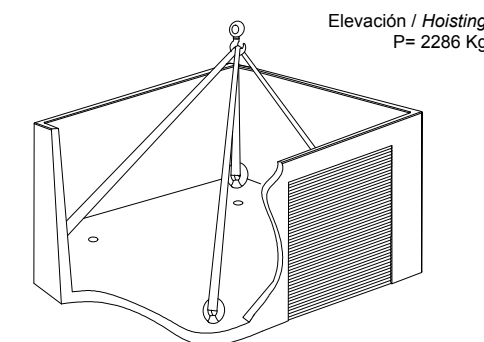

Elevación / Hoisting  
 P= 2286 Kg

3 Verter resina epoxy / Pour resin epoxy

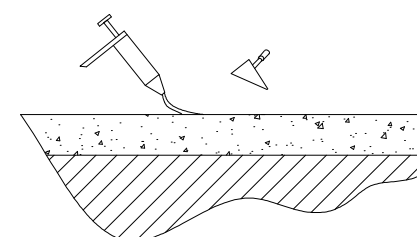

4 Instalar sobre la resina epoxy / Install over resin epoxy

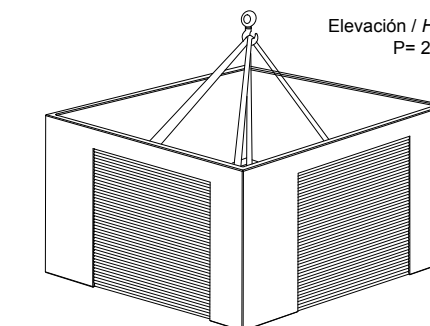

Elevación / Hoisting  
 P= 2286 Kg

**ESPECIFICACIONES / SPECIFICATIONS**

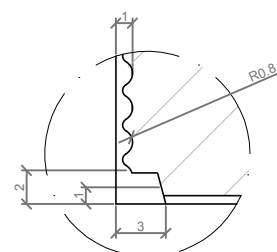

DETALLE N / DETAIL N

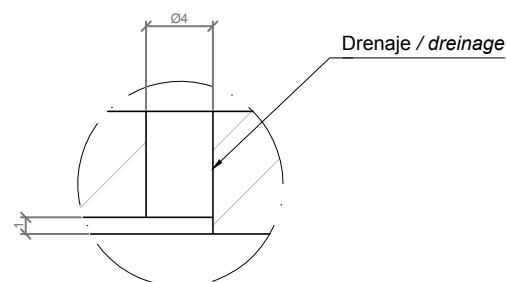

DETALLE M / DETAIL M

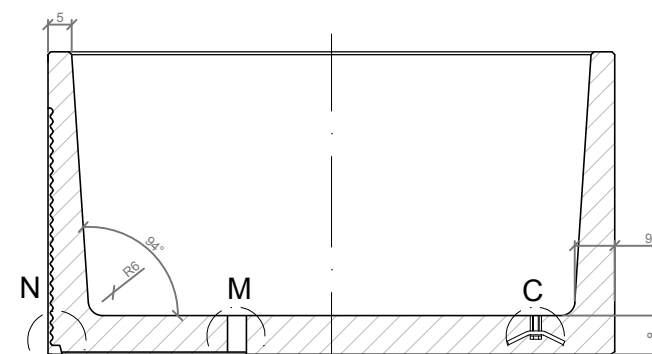

SECCIÓN A-A' / SECTION A-A'

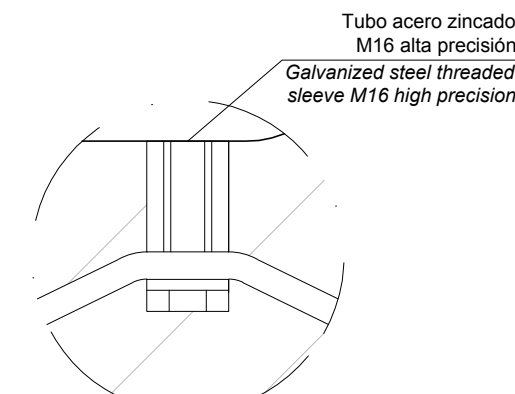

DETALLE C / DETAIL C