

CARACTERÍSTICAS / FEATURES



**Material** hormigón Petra 1  
**Acabado** decapado e hidrofugado  
**Dimensiones** l. 190, a. 190, h. 80 cm  
**Color** ver carta de colores  
**Fijación** apoyado por su propio peso o mediante resina epoxi  
**Peso** 1726 Kg / 1510 L  
**Palet** 200 x 200 cm

**Material** precast concrete Petra 1  
**Finish** etched and waterproofed  
**Dimensions** l. 190, w. 190, h. 80 cm  
**Colour** see colour catalogue  
**Fixing** resting on the ground or with epoxy resin  
**Weight** 1726 Kg / 1510 L  
**Pallet** 200 x 200 cm

diseñador / design: Ton Riera

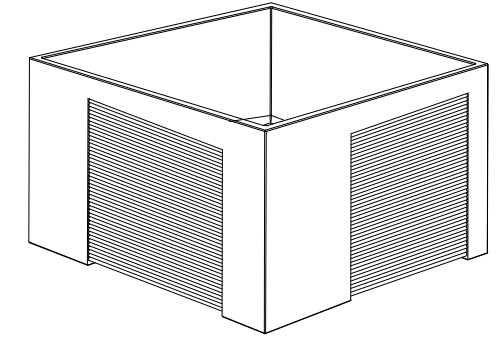

TANIT L-80

GEOMETRIA / GEOMETRY

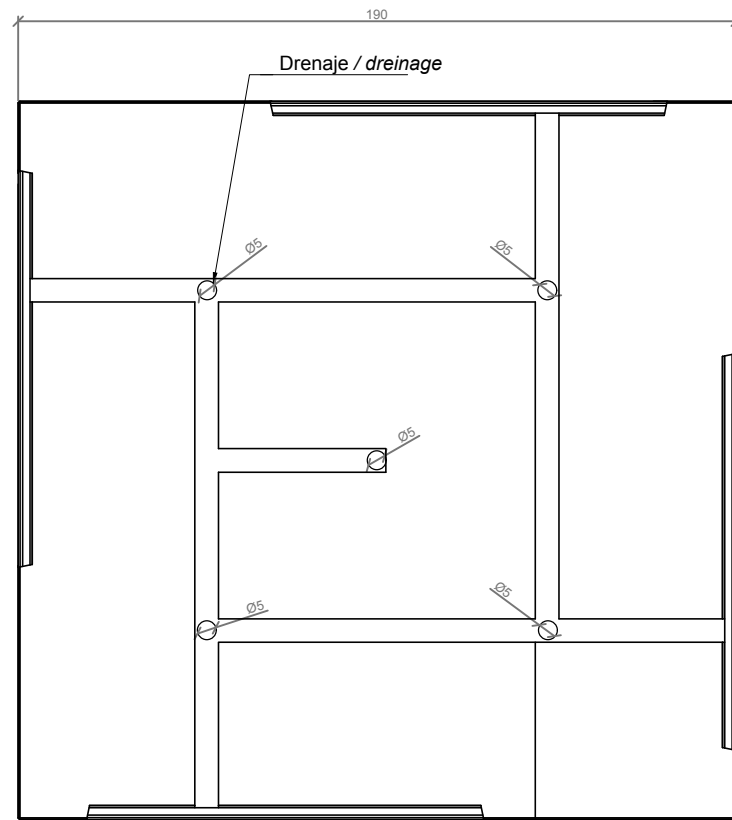

VISTA INFERIOR / BOTTOM VIEW

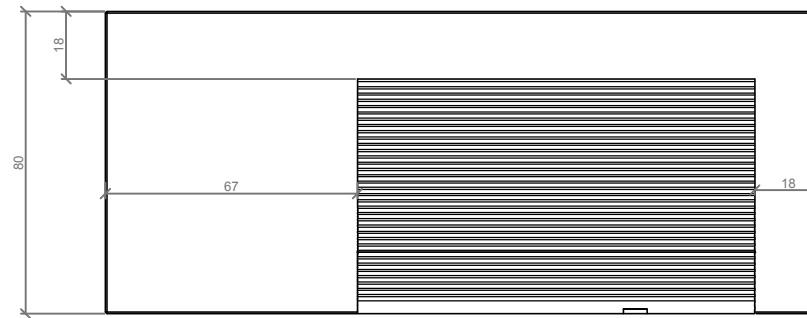

ALZADO / FRONT VIEW

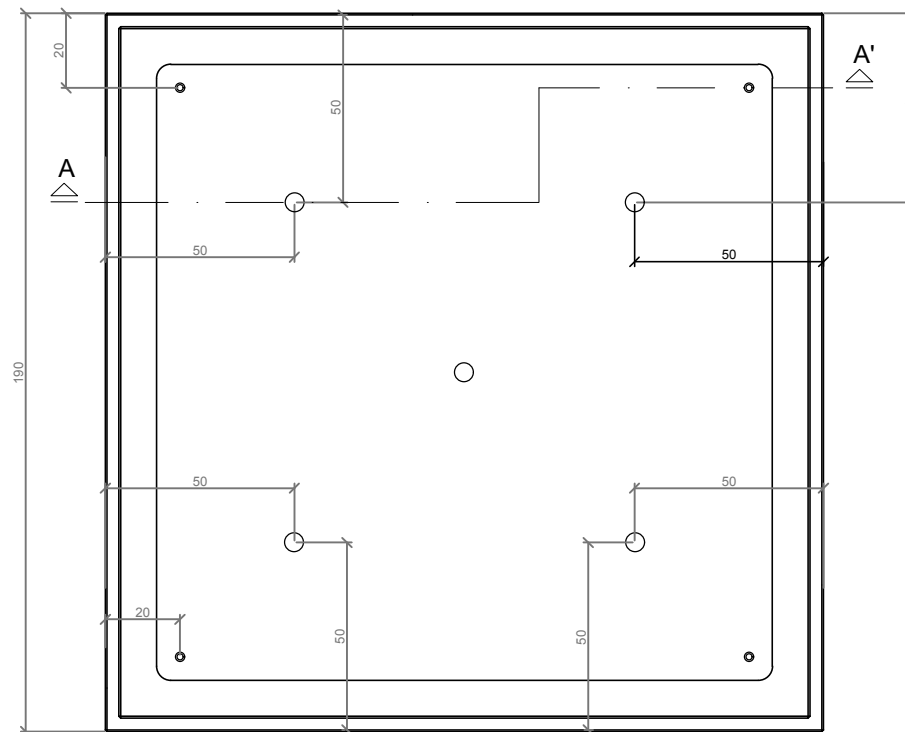

PLANTA / TOP VIEW

ESC. 1:20

MANIPULACIÓN E INSTALACIÓN / HANDLING AND INSTALLATION

- 1 Enroscar cáncamo al casquillo roscado  
 Thread the eyebolt on the thread sleeve

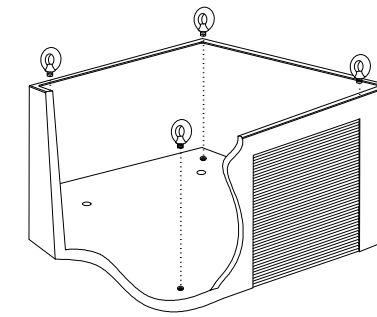

- 2 Elevar mediante eslingas / Lifting with slings

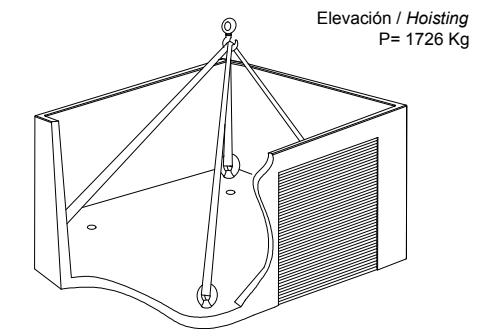

- 3 Verter resina epoxy / Pour resin epoxy

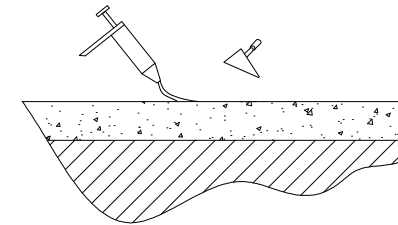

- 4 Instalar sobre la resina epoxy / Install over resin epoxy

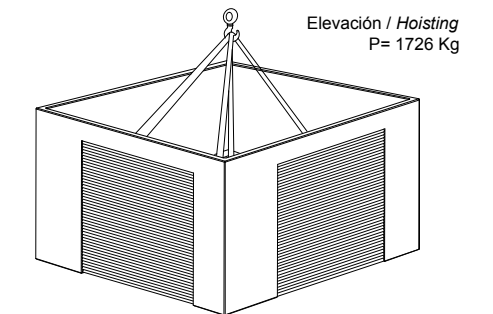

ESPECIFICACIONES / SPECIFICATIONS

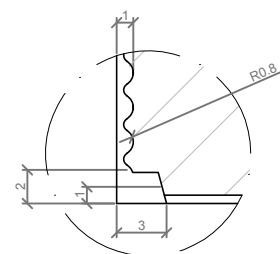

DETALLE N / DETAIL N

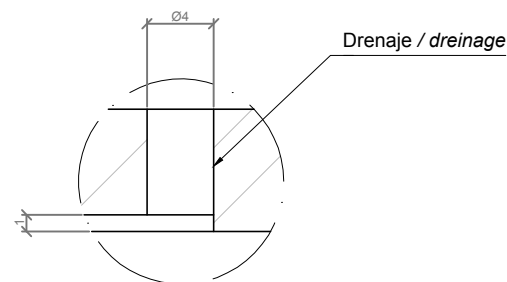

DETALLE M / DETAIL M

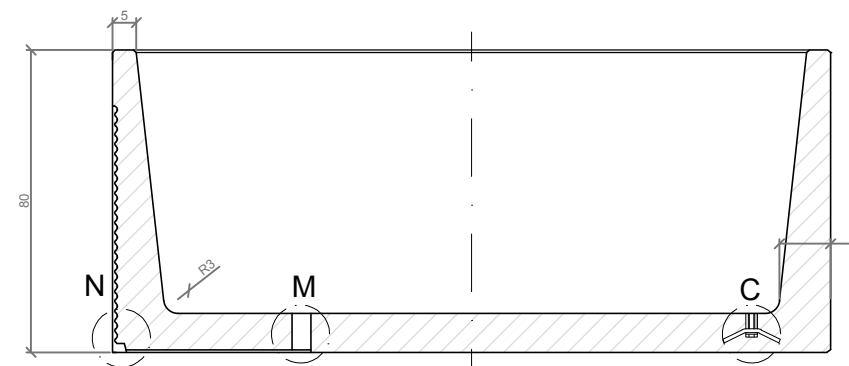

SECCIÓN A-A' / SECTION A-A'

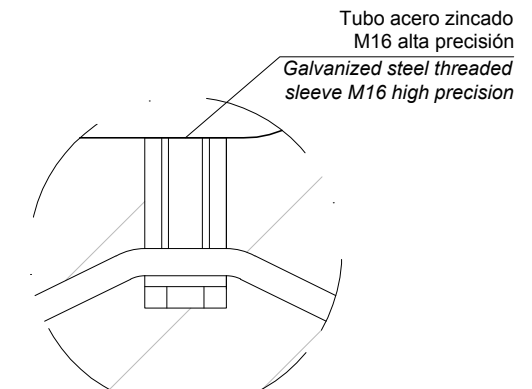

DETALLE C / DETAIL C